

BY	CHK	REVISION RECORD MODIFICATIONS	DATE	REV.
ALLEN		RELEASE TO PRODUCTION	2007,8,2	1.0

SPECIFICATION

Current Rate: 1.5 AMP
 Insulation Resistance: 1000mΩ Min
 Contact Resistance: 20mΩ Max
 Dielectric voltage: 500V AC for one minute
 Operation Temperature: -40°C to +105°C

MATERIAL

Insulator: Polyester, UL94v-0

Standard: Nylon 6T

Contact Pin: Brass

Finish: Tin, Gold Plated

Standard: Gold Flash all over

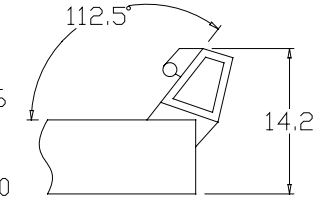
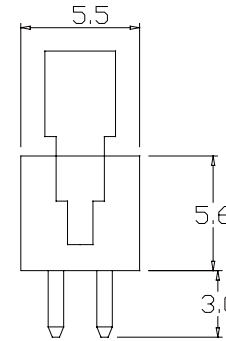
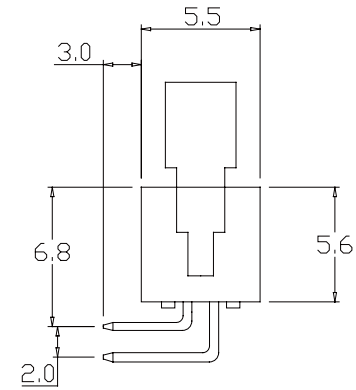
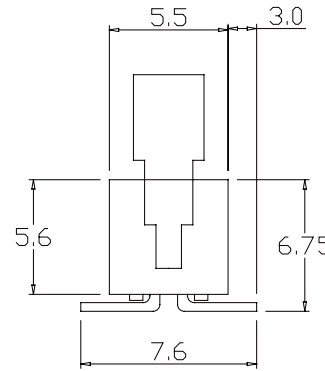
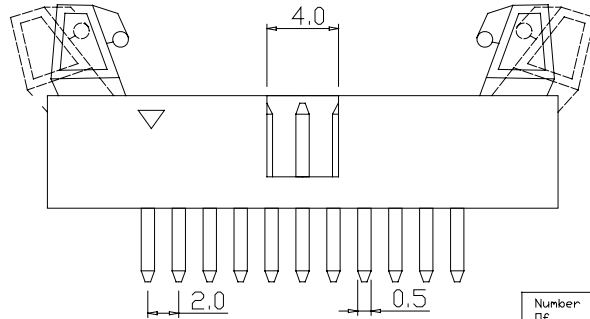
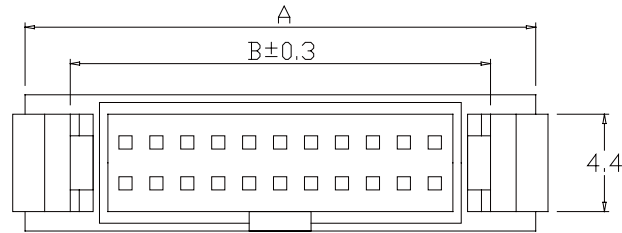

Number of Position	DIMENSION		
	A	B	C
20	34.0	26.3	18.0
26	40.0	32.3	24.0
40	54.0	46.3	38.0
44	58.0	50.3	42.0
50	64.0	56.3	48.0
60	82.0	74.3	66.0

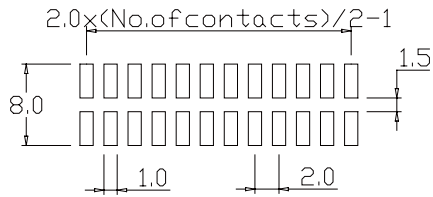
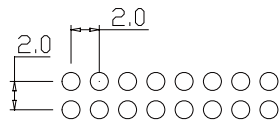

Recommended PCB Layout
 (PCB TOLERANCE±0.05)

E D H 2 X - X X X B - 2 - U

S: Straight
 R: Right Angle
 M: SMT

No. of contacts

G: Gold flash S: Selective
 GA: Gold 5u" SA: Selective 5u"
 GB: Gold 10u" SB: Selective 10u"
 GC: Gold 20u" SC: Selective 20u"
 GD: Gold 30u" SD: Selective 30u"
 T: Tin Plated TE: Tin 200u"

B: Black Insulator

URoHS+Nylon6T

APPRO	CHECK	DRAWN	PART NO.	DEH2X-XXXB-2-U		
			ITEM NO.			
			DRAW NO.			
			UNIT	mm	SCALE	no
			TOLER		NO.	

DESCRIPTION